

7 Proper use of the sealer

Before using this machine, please read “Proper usage of the sealer” carefully and operate the sealer. Use the machine only as described in this manual. If the machine is not used in accordance with this manual, it may result in malfunction of the sealer, causing the risk of danger.

7-1 Place the machine

FCB-200 is a tabletop type sealer. Place the machine on the flat place or the worktable.

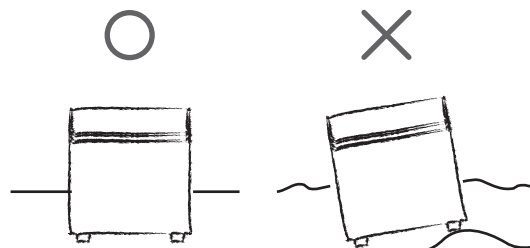

7-2 Plugging in the electrical power cord

Insert the power plug, located on the backside of the sealer, into the wall outlet fully.

Warning There is a danger of fire if the electrical power source does not meet proper specifications.

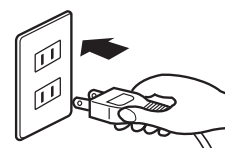

7-3 Power switch ON

After turning ON the overheating prevention device located backside of the sealer, turn ON the power switch on the control panel. Display will turn ON. (Counter value will be indicated on the display.)

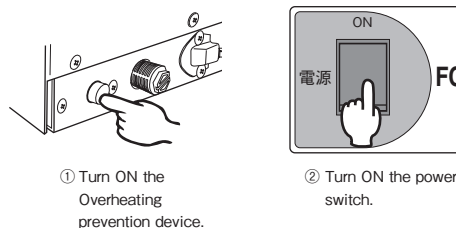

7-4 Setting the sealing condition with a control panel

Set heating temperature /heating time /cooling temperature/ vacuum degree with a control panel.

The value may differ according to the types or thickness of the films. Set the value accordingly. By pushing the “mode change” button, the display will show the each set values in the order below. Counter value → Heating temperature → Heating time → Cooling temperature → Vacuum degree Selected mode indicator lamp is turned on.

When all the mode indicator lamps are turned off, the display shows counter value.

TIPS Press the “mode change” button, and then up/down arrow key while the modes indicator lamp is OFF in order to reset the seal count to “0000” .

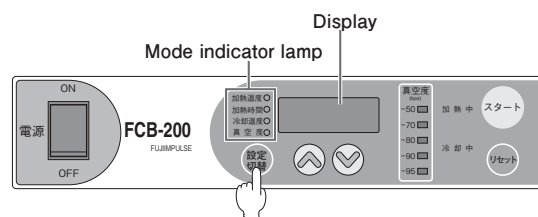

□ **Setting the heating temperature**

- Press the up/down arrow key when the “heating temperature” mode is shown on the display. [Setting range: 60 ~ 200 Celsius]
- Optimum heating temperature varies depending on the material of the film.
- Set the heating temperature at minimum required to conduct sealing. This will increase the work efficiency and saves the life of consumable parts.

□ **Setting the heating time**

- Press the up/down arrow key when the “heating time” mode is shown on the display. [Setting range: 0.0 ~ 3.0 sec.]
- Under the temperature controlling system, the set heating temperature is maintained during the set heating time. Therefore, sealing can be made even if the heating time is set 0.0 sec. Set the heating time only when the sealing cannot be made even after raising the temperature or when the set temperature is too high and damaging the film.

This graph shows the temperature change when the heating time is set at “0” .

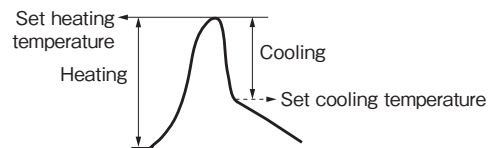

This graph shows the temperature change when the optimum heating time is set.

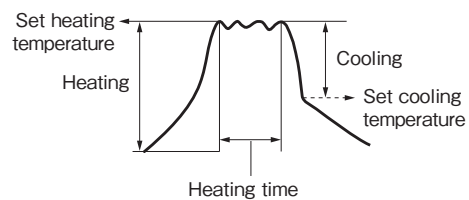

□ **Setting the cooling temperature**

- Press the up/down arrow key when the “cooling temperature” mode is shown on the display. [Setting range: 60 ~ 200 Celsius]

□ **Setting the vacuum degree**

- Press the up/down arrow key when the “vacuum degree” mode is shown on the display. [Setting range: -50 ~ -100kpa]

Setting procedure for each mode

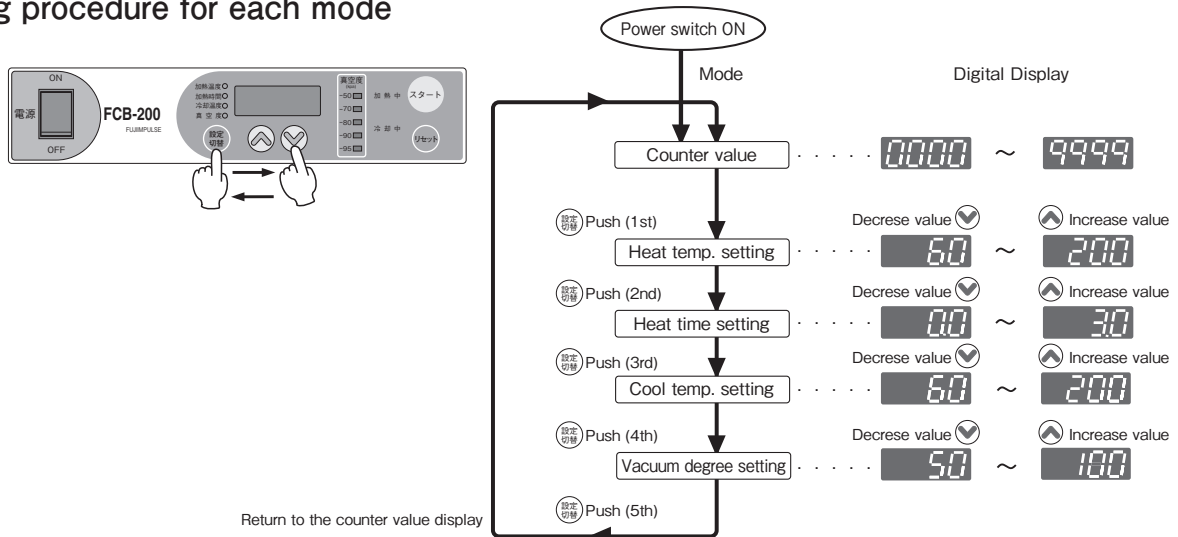

Setting procedure for each mode

Example:

Heating temperature 180°C Heating time 0.8 Cooling temperature 100°C Vacuum degree -50kpa

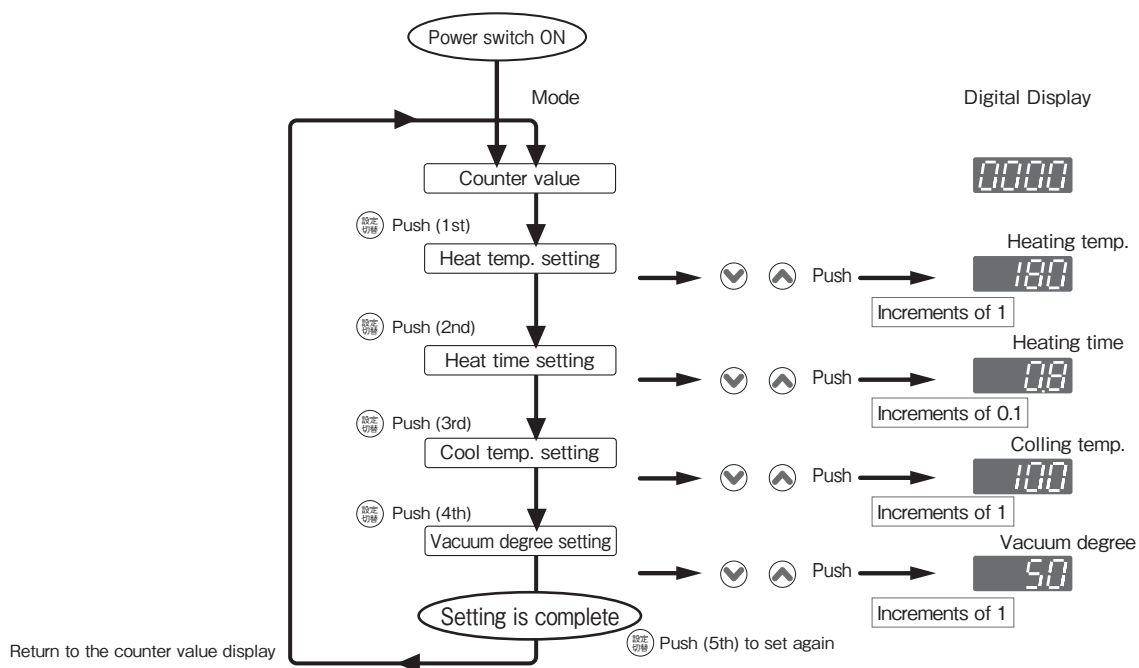

7-5 Situate a pouch to the sealing area

Open the chamber cover, and situate the pouch/film between the seal receiving plate and the pressure plate.

- Caution** Do not put hot, just-cooked food inside the chamber.
- Caution** When situating the pouch/film to the sealing area, make sure the pouch is stretched enough to both sides to avoid wrinkles of the seal.
- Caution** Be careful of attaching drips or oil to the sealing area since it may cause sealing deflection.
- TIPS** Please use the guide plate and guide base if it is difficult to locate the pouch/film to the sealing area.

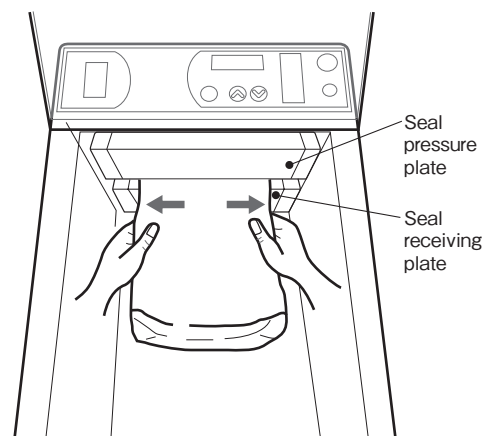

7-6 Close the chamber cover and push the START button

The following procedures are automatically operated.

1. Vacuum pump starts sucking air inside the chamber.
2. Displays vacuum degree inside the chamber on the display.
3. Vacuum pump stops when the set vacuum degree is achieved.
4. Starts sealing (heating & cooling).
5. Sealing is complete when the machine beeps 4 times.

Attention! Press the "Reset" button in order to stop operation while under the operation.

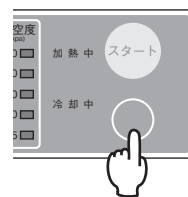
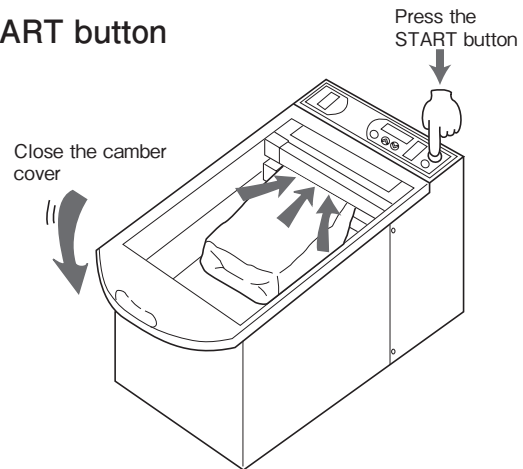

7-7 Sealing is complete

Open the chamber cover and take the pouch/film out.

If the sealing is messy, please set the sealing condition again.

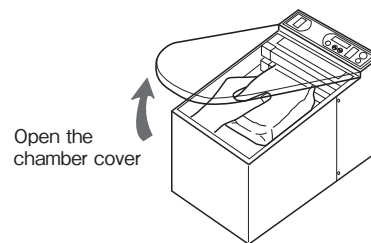

7-8 How to finish operation

1. After turning OFF the power switch at the control panel, the vacuum pump will start running no-load (dry) operation for 3 minutes and finish automatically.

Caution Do not unplug from the wall outlet while under no-load operation.

Caution Please run no-load operation after finishing all operations.

2. Unplug the power plug from the wall outlet after finishing no-load operation.

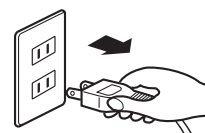
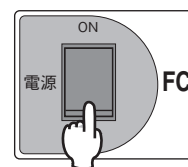

When not using the machine for a while, please unplug the power plug as well.

Pull out the power plug with your hands.